

POCKET VOL. FIRE DEPT. PUMPER/TANKER

TID NO. 13187



BODY

- Bolted Painted Stainless Steel Body
- ROM Roll Up Doors
- Hosebed Hard Suction Storage
- Roll-Out SCBA Storage Tray
- Rear Mounted Ladder for Easy Hosebed Access
- Rear Bumper Hosebed

TANK

- UPF 2100 Gallon Tank
- ICI SL Plus Tank Gauge
- (2) Syntex 2100 Portable Tanks
- (2) Painted Manual Porta-Tank Racks
- (2) Rear 2.5" Direct Tank Fills
- Rear Manual Swivel Dump Chute with Electric Valve

ELECTRICAL

- ILLI LED Strip Compartment Lighting
- Whelen Warning Lighting
- Whelen LED Arrowstick
- Whelen Scene Lighting

CHASSIS

- Freightliner M2 112 2 Door
- Cummins ISL9 400 Engine
- 3000 EVS Transmission
- Back Up Camera
- Custom Lettering and Striping

PUMP

- Hale MBP 1000 GPM Pump
- Fire Research Pump Boss Pressure Governor
- (2) 1.75" Crosslays
- Left side: (2) 2.5" Discharges
2.5" Intake
Master Intake
- Right side: (2) 2.5" Discharges
2.5" Intake
Master Intake
- Booster Reel

AUTHORIZED DEALER

**Melton Fire Group
Tracy Melton**

P 803-447-0316

tmelton13@gmail.com

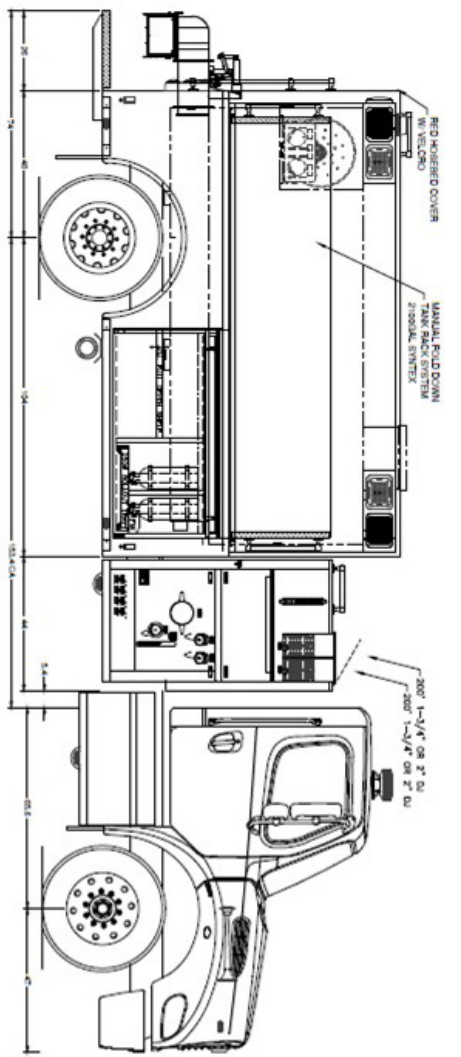
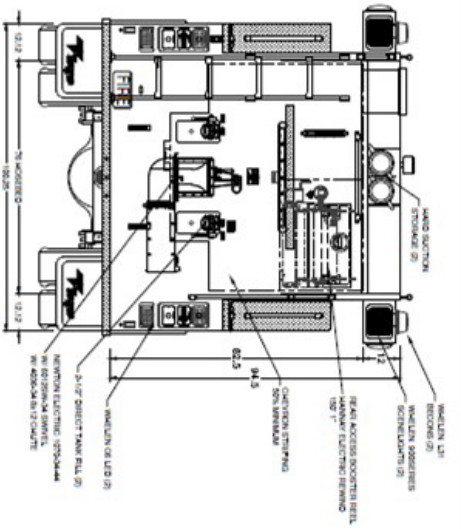

COMP.	HEIGHT	WIDTH	USPFS	USPFS LOWER	SPACE	HT.
DRW	36.62	71.85	10	28	28	33.87
FRW	36.62	71.85	10	28	28	33.87
HOSIERS	17	7.5	-	100	-	53.84
FRONT X-LAY	16	7.5	-	73.75	-	5.12
REAR X-LAY	16	7.5	-	73.75	-	5.12

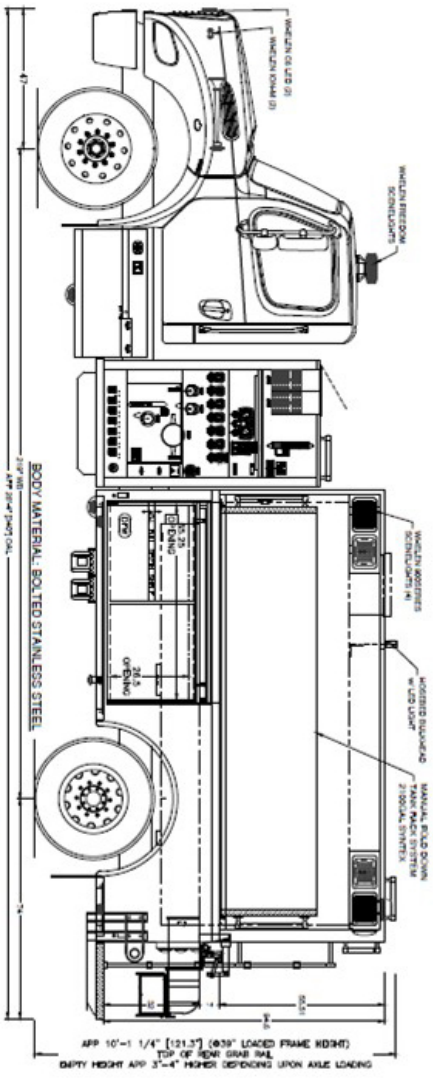
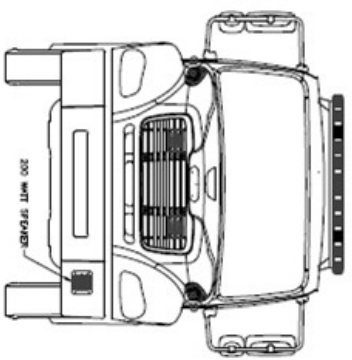
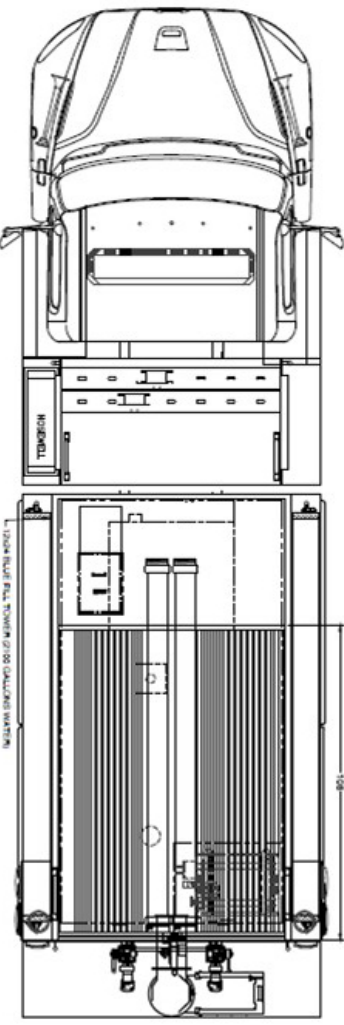

NOTE:
 DIMENSIONS SHOWN ARE APPROXIMATE AND ARE SUBJECT TO MINOR CHANGE AS MAY BE FOUND NECESSARY DURING CONSTRUCTION. MINOR DETAILS MAY NOT BE SHOWN. IF DISCREPANCIES EXIST BETWEEN THIS DRAWING AND THE WRITTEN SPECIFICATIONS PROVIDED BY TOYNE, THE WRITTEN SPECIFICATIONS SHALL PREVAIL.

ORIGINAL DRAWING	284P/L21	CHASSIS:	FREIGHTLINER M2 112 200OR 4x2	SCALE:	1:66	SHEET:	A
ISR	28MAV21	WB-CAR:	219'-153.4'-47" D17	CITY:	POCKET		
CO 1	28JUN21	BODY MATL:	BOLTED STAINLESS STEEL	STATE:	--		
CO 2	09AUL21	PUMP:	HALE MPF 1000	DUR:	MEL		
		TANK:	2100 UPF POLY-TANK III	CAD:	GROSSMAN		
		FOAM SYSTEM:	N/A	DATE:	21 APRIL 2021		
		GENERATOR:	N/A	FILE:	POCKET21		

Toyne
 BREDA, IA 51438
 800 648-3358
 WWW.TOYNE.COM

POCKET
 CUSTOM TRANSPORTER